



## EIZO – IP SOLUTIONS

EIZO's IP solutions optimize video surveillance in security control rooms and remote control centers with their unique features. They can be integrated perfectly with your existing security platform or your existing video management system (VMS). The solutions are designed for 24/7 use and boast exceptional reliability and longevity.

### An overview of the advantages

---

- ✔ Connection to IP video surveillance system without a computer
- ✔ Particularly suitable for use in video walls, installations with large screen sizes and high resolutions, live viewing in shops, buildings and outdoor areas, access control systems and in manufacturing
- ✔ High reliability and long product life cycles
- ✔ Low TCO (Total Cost of Ownership) thanks to maintenance-free operation that does not require virus scanners, security updates, operating system maintenance or software licensing
- ✔ Suitable for round-the-clock use, seven days a week (24/7 operation)
- ✔ Ideal also for sensitive infrastructures due to simple installation with fewer cables and hardware

# IP SOLUTIONS

In video surveillance, the use of computers is often undesirable, uneconomical or even impossible due to space constraints. EIZO offers a range of solutions specifically designed to meet a wide variety of requirements. The range includes monitors with integrated decoding and a standalone box solution that can be flexibly combined with different screen sizes and resolutions up to 4K UHD, as well as a streaming gateway box that ensures secure and efficient transmission and conversion of video data between cameras and central systems, even with limited bandwidth.

## Example of a conventional installation

Traditional security solutions require a wide range of hardware, software, cabling, and other components as well as significant time and effort for installation and maintenance throughout the entire lifecycle of the system. The more components a system has, the more potential sources of error there are that could compromise the security of the monitored area.

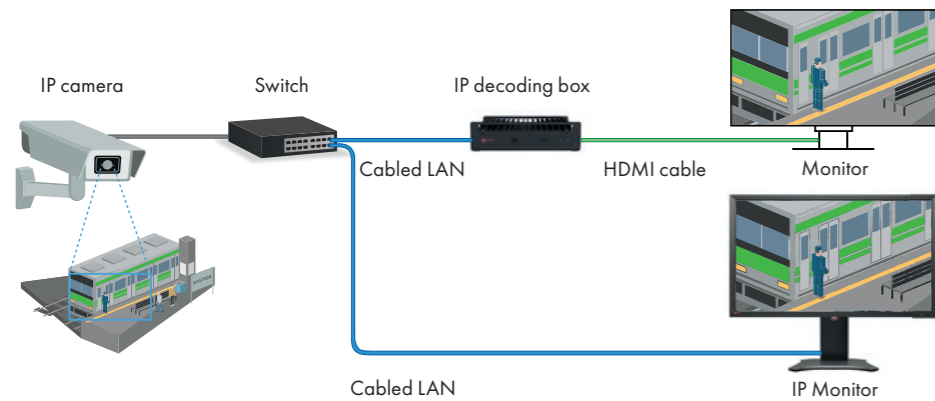
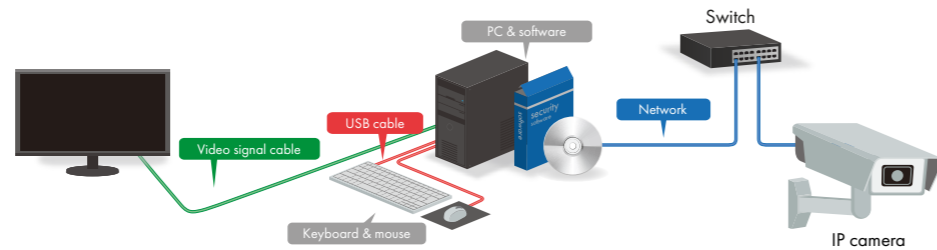

## Integrated solution with IP decoding products

IP decoding solutions are connected directly to an IP camera or a switch via LAN, enabling instant video streaming for real-time surveillance. The decoding solutions can be conveniently controlled via a web interface or an API integrated into the VMS, and also allow control of the IP surveillance cameras.

## IP video transcoder

The SGX0031 streaming gateway box transmits video content from IP cameras for live viewing. In merge mode, video streams from multiple IP cameras are combined into a single video stream and transmitted with extremely low latency. RTSP and SRT protocols ensure stable transmission even with limited bandwidth or unstable networks. Support for the RTP protocol enables flexible integration into various system environments.

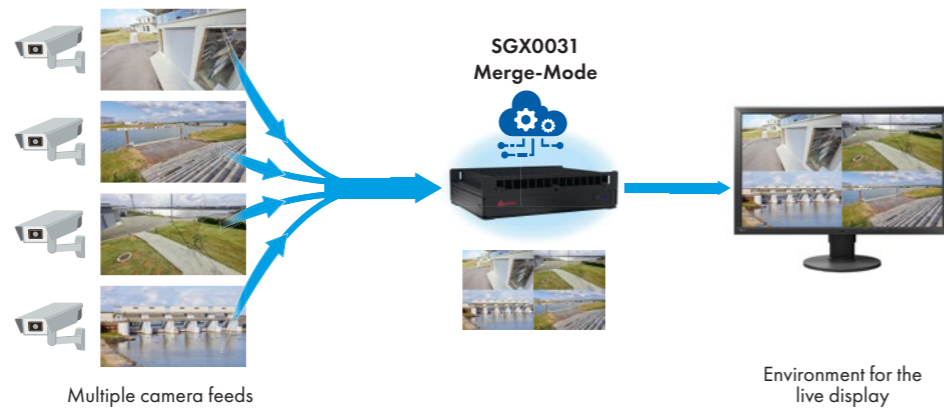

## IP decoding monitors



Built-in decoder in the monitor

## IP decoding box



The decoder can be used with monitors of any size

## Streaming gateway box



Camera video transcoding for stable transmission

# SUITABLE FOR SENSITIVE INFRASTRUCTURES

## Integrated alarms over the network

IP decoding solutions support custom integration with local security systems through a web API to enable response to alarms over the network. This includes predefined actions such as layout customization, display of messages, audio activation, camera adjustment, masking, power-on status and more. Linking and integration into the workflow ensures that the most relevant information is displayed at the right time to quickly respond to situations.

## Data protection and viewing of camera images

Sometimes live video is required, but storage of images is not allowed. The IP decoding solutions allow only for the live display of videos. Operators have no way of accessing or exporting video streams. Possible scenarios involve hospitals, prisons, public spaces, checkout counters, front desks and applications for the protection of people.

# COOPERATIVE PARTNERS

EIZO works together with leading providers of security and monitoring solutions to ensure technical compatibility\* and functional support. It also develops joint solutions for fulfilling individual customer requirements.

## Camera partners



## VMS partners



\* Please check the EIZO website for compatibility: [www.eizo.eu/ip-compatibility](http://www.eizo.eu/ip-compatibility)

IP decoding monitors

IP decoding box



	fdf2731w-ip	fdf2312w-ip	dx0231-ip	sgx0031
<b>Model variants</b>	With stand, black	With stand, black	-	-
<b>Display</b>				
Panel technology	VA	IPS	-	-
Screen size	27" / 68,6 cm	23" / 58 cm	-	-
Ideal and recommended resolution	1920 × 1080 (16:9)	1920 × 1080 (16:9)	-	-
Visible image size (H × V)	597.6 × 336.2 mm	509.2 × 286.4 mm	-	-
Pixel pitch	0.311 × 0.311 mm	0.265 × 0.265 mm	-	-
Displayable colours	16.7 million colours	16.7 million colours	-	-
Max. viewing angle (H/V, typical)	178°, 178°	178°, 178°	-	-
Max. brightness (typical)	350 cd/m <sup>2</sup>	300 cd/m <sup>2</sup>	-	-
Max. contrast (typical)	3000:1	1000:1	-	-
Typical reaction time	12 ms (black-white-black)	8 ms (grey-grey)	-	-
<b>IP decoding</b>				
Number of max. camera registrations	48	16/48 <sup>2</sup>	48	48
Number of simultaneous streams	32	16/32 <sup>2</sup>	32	32
Supported protocols	ONVIF Profile S, Axis VAPIX, Panasonic/i-Pro, RTSP	ONVIF Profile S, Axis VAPIX, Panasonic/i-Pro, RTSP	ONVIF Profile S, Axis VAPIX, Panasonic/i-Pro, RTSP	ONVIF Profile S, Axis VAPIX, Panasonic/i-Pro, RTSP
Video compression	H.265, H.264, MJPEG	H.265, H.264, MJPEG	H.265, H.264, MJPEG	H.265, H.264, MJPEG
Display performance <sup>1</sup>	4 Streams: 3840 × 2160 / 20 fps 16 Streams: 1920 × 1080 / 20 fps 32 Streams: 1280 × 720 / 15 fps	4 Streams: 3840 × 2160 / 20 fps 16 Streams: 1920 × 1080 / 20 fps 32 Streams: 1280 × 720 / 15 fps	4 Streams: 3840 × 2160 / 20 fps 16 Streams: 1920 × 1080 / 20 fps 32 Streams: 1280 × 720 / 15 fps	4 Streams: 3840 × 2160 / 20 fps 16 Streams: 1920 × 1080 / 20 fps 32 Streams: 1280 × 720 / 15 fps
Maximum bitrate	8192 kbps	8192 kbps	8192 kbps	8192 kbps
Full screen	1920 × 1080 / 30 fps	1920 × 1080 / 30 fps	3840 × 2160 / 20 fps	-
<b>Video signals</b>				
Signal input	IP camera/network: RJ-45	IP camera/network: RJ-45	IP camera/network: RJ-45	IP camera/network: RJ-45
Signal output	-	HDMI	HDMI × 2	-
Max. resolution monitor signal	-	1920 × 1080 / 60 Hz	3840 × 2160 / 60 Hz	-
Digital frequency (H/V)	-	HDMI: 31–68 kHz / 49–61 Hz	31–135 kHz / 49–61 Hz	-
<b>Network</b>				
LAN standards	IEEE802.3ab (1000BASE-T) IEEE802.3u (100BASE-TX)	IEEE802.3ab (1000BASE-T) IEEE802.3u (100BASE-TX)	IEEE802.3ab (1000BASE-T) IEEE802.3u (100BASE-TX) IEEE802.3at Type2 (PoE+)	IEEE802.3ab (1000BASE-T) IEEE802.3u (100BASE-TX) IEEE802.3at Type2 (PoE+)
USB	USB 2.0: Typ-A × 2	USB 2.0: Typ-A × 2	USB 2.0: Typ-A	-
<b>Electrical data</b>				
Power supply	AC 100–240 V, 50 / 60 Hz	AC 100–240 V, 50 / 60 Hz	PoE+: 42.5 V–57 V (48 V typ.) Power supply unit (optional): DC12 V ± 10%	PoE+: 42.5 V–57 V (48 V typ.) Power supply unit (optional): DC12 V ± 10%
Max. power consumption	55 W	49 W	PoE+: 25.5 W Power supply unit (optional): 24 W	PoE+: 25.5 W Power supply unit (optional): 24 W
<b>Functionalities</b>				
Communication protocols	DHCP, DNS, HTTP, HTTPS, LDAP, NTP, RTP, RTSP, SNMP, SRTP <sup>2</sup> , IEEE802.1X	DHCP, DNS, HTTP, HTTPS, LDAP <sup>2</sup> , LDAPS <sup>2</sup> , NTP, RTP, RTSP, SNMP, SRTP <sup>2</sup> , SRTP <sup>2</sup> , IEEE802.1X <sup>2</sup>	DHCP, DNS, HTTP, HTTPS, LDAP, NTP, RTP, RTSP, SNMP, SRTP <sup>2</sup> , IEEE802.1X	DHCP, DNS, HTTP, HTTPS, LDAP, NTP, RTP, RTSP, SNMP, SRTP <sup>2</sup> , IEEE802.1X
Streaming protocols	RTP (H.265, H.264, MJPEG, MPEG2-TS), SRTP (H.265, H.264) <sup>2</sup> , UDP (MPEG2-TS)	RTP (H.265, H.264, MJPEG, MPEG2-TS), SRTP (H.265, H.264) <sup>2</sup> , SRTP (H.265, H.264) <sup>2</sup> , UDP (MPEG2-TS)	RTP (H.265, H.264, MJPEG, MPEG2-TS), SRTP (H.265, H.264) <sup>2</sup> , UDP (MPEG2-TS)	RTP (H.265, H.264, MJPEG, MPEG2-TS), SRTP (H.265, H.264) <sup>2</sup> , SRTP (H.265, H.264) <sup>2</sup> , UDP (MPEG2-TS)
Features	Image masking, Advanced event response, Playback of camera recordings <sup>2</sup> , Live remote view in Web UI <sup>2</sup> , Screen rotation <sup>2</sup>	Image masking, Advanced event response, Playback of camera recordings <sup>2</sup> , Live remote view in Web UI <sup>2</sup> , Screen rotation <sup>2</sup> , VMS failover <sup>2</sup>	Image masking, Advanced event response, Playback of camera recordings <sup>2</sup> , Live remote view in Web UI <sup>2</sup> , Screen rotation <sup>2</sup>	-
Audio codec	OPUS, G711, G726, AAC	-	OPUS, G711, G726, AAC	-
Audio	2 × 1 Watt speakers	-	Stereo Klinke, 2 x HDMI	-
VMS support	Genetec, Milestone <sup>2</sup> , Mobotix <sup>2</sup> , Siemens, Qognify <sup>2</sup>	Genetec, Milestone <sup>2</sup> , Mobotix <sup>2</sup> , Siemens, Qognify <sup>2</sup>	Genetec, Milestone <sup>2</sup> , Mobotix <sup>2</sup> , Siemens, Qognify <sup>2</sup>	-
<b>Dimensions and weight</b>				
Dimensions (W × H × D)	643 × 531.5 × 205 mm	547.2 × 411.3 × 157 mm	165 mm × 44.2 mm × 130 mm	165 mm × 44.2 mm × 130 mm
Dimensions without stand (W × H × D)	634 × 376 × 60,5 mm	547.2 × 324.4 × 59,5 mm	-	-
Weight/without stand	7.4 kg / 5.5 kg	6.6 kg / 4.2 kg	720 g / -	720 g / -
Tilt range front/back/pivot	0° / 30° / 90°	0° / 30° / -	-	-
VESA attachment	100 x 100 mm	100 x 100 mm	-	-
<b>Ambient conditions</b>				
Operating temperature	0–40 °C	0–40 °C	0–40 °C	0–40 °C
Ambient humidity (RH, non-condensing)	20–80%	20–80%	20–80%	20–80%
<b>Accessories included</b>	Power cable, set-up guide, manual via download	Power cable, set-up guide, manual via download	HDMI cable (0.5 m), set-up guide, manual via download	Set-up guide, manual via download
<b>Optional accessories</b>	-	-	VESA VOP-01 offset plate, VESA VESAMP100 mounting panel, DVAC-01 power supply unit	VESA VOP-01 offset plate, VESA VESAMP100 mounting panel, DVAC-01 power supply unit
<b>Certifications and standards (Up-to-date information is available from EIZO)</b>	CB, CE, UKCA, cTUVus, FCC-A, CAN ICES-3 (A), TUV/S, PSE, VCCI, RCM, RoHS, WEEE, CCC, China RoHS	CB, CE, UKCA, cTUVus, FCC-A, CAN ICES-3 (A), TUV/S, PSE, VCCI, RCM, RoHS, WEEE, CCC, China RoHS	CB, CE, UKCA, cTUVus, FCC-A, CAN ICES-3 (A), VCCI-A, RCM, RoHS, WEEE	CB, CE, UKCA, cTUVus, FCC-A, CAN ICES-3 (A), VCCI-A, RCM, RoHS, WEEE
<b>Warranty</b>	2 years (24/7 use)	2 years (24/7 use)	2 years (24/7 use)	2 years (24/7 use)

<sup>1</sup> Performance depends on the resolution and number of streams.  
Due to the current state of LCD technology, a panel may contain a limited number of missing or flickering pixels.

<sup>2</sup> Available with optional licenses.

All product names are trademarks or registered trademarks of the EIZO Corporation in Japan and in other countries, or trademarks or registered trademarks of the respective company. Find your local sales partners or EIZO contact persons: [eizo.eu/contact](http://eizo.eu/contact)

Copyright © 2026 EIZO Europe GmbH, Belgrader Str. 2, 41069 Mönchengladbach, Germany.  
All rights, errors and modifications are subject to change. Last updated: 04/2026

